

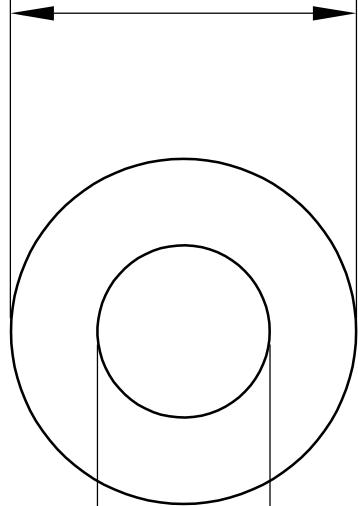

$\text{Ø}0.875'' \pm 0.005$

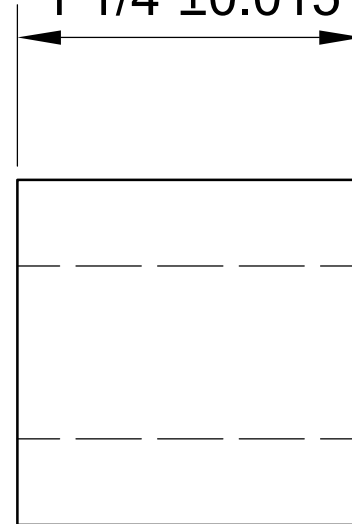

$1 \frac{1}{4}'' \pm 0.015$



$\text{Ø}0.75'' \pm 0.005$

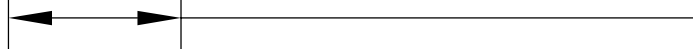

LILY[®]

SHANGHAI LILY BEARING LIMITED

Email: lilybearing@lily-bearing.com

Part
Number

6389K225 Light Duty
Dry-Running Nylon Sleeve Bearing